

TOWN AND COUNTRY PLANNING ACT 1990

Land adjacent to 98 Linkside, Bretton

Tree Preservation Order 14/00005/TPO

The Council of the City of Peterborough, in exercise of the powers conferred on them by section 198 of the Town and Country Planning Act 1990 make the following Order—

1. Citation

- (1) This Order may be cited as Land adjacent to 98 Linkside, Bretton Tree Preservation Order (14/00005/TPO).

2. Interpretation

- (1) In this Order "the authority" means the Council of the City of Peterborough
- (2) In this Order any reference to a numbered section is a reference to the section so numbered in the Town and Country Planning Act 1990 and any reference to a numbered regulation is a reference to the regulation so numbered in the Town and Country Planning (Tree Preservation)(England) Regulations 2012.

3. Effect

- (1) Subject to article 4, this Order takes effect provisionally on the date on which it is made.
- (2) Without prejudice to subsection (7) of section 198 (power to make tree preservation orders) or subsection (1) of section 200 (tree preservation orders: Forestry Commissioners) and, subject to the exceptions in regulation 14, no person shall—
- (a) cut down, top, lop, uproot, wilfully damage, or wilfully destroy; or
 - (b) cause or permit the cutting down, topping, lopping, uprooting, wilful damage or wilful destruction of,

any tree specified in the Schedule to this Order except with the written consent of the authority in accordance with regulations 16 and 17, or of the Secretary of State in accordance with regulation 23, and, where such consent is given subject to conditions, in accordance with those conditions.

4. Application to trees to be planted pursuant to a condition

- (1) In relation to any tree identified in the first column of the Schedule by the letter "C", being a tree to be planted pursuant to a condition imposed under paragraph (a) of section 197 (planning permission to include appropriate provision for preservation and planting of trees), this Order takes effect as from the time when the tree is planted.

Dated this 27/8/14

The Common Seal of Council of the City of Peterborough
was affixed to this Order in the presence of:

.....

Authorised by the Council to sign in that behalf



SCHEDULE

Specification of trees

Trees specified individually

(encircled in black on the map)

<i>Reference on map</i>	<i>Description</i>	<i>Situation</i>
T1	Lime (<i>Tilia sp</i>)	E516618 N302131
T2	Ash (<i>Fraxinus excelsior</i>)	E516610 N302107
T3	Ash (<i>Fraxinus excelsior</i>)	E516605 N302098

Trees specified by reference to an area

(within a dotted black line on the map)

<i>Reference on map</i>	<i>Description</i>	<i>Situation</i>
-----------------------------	--------------------	------------------

None

Groups of trees

(within a broken black line on the map)

<i>Reference on map</i>	<i>Description (including number of trees of each species in the group)</i>	<i>Situation</i>
-----------------------------	---	------------------

None

Woodlands

(within a continuous black line on the map)

<i>Reference on map</i>	<i>Description</i>	<i>Situation</i>
-----------------------------	--------------------	------------------

None

J. Ans
6025

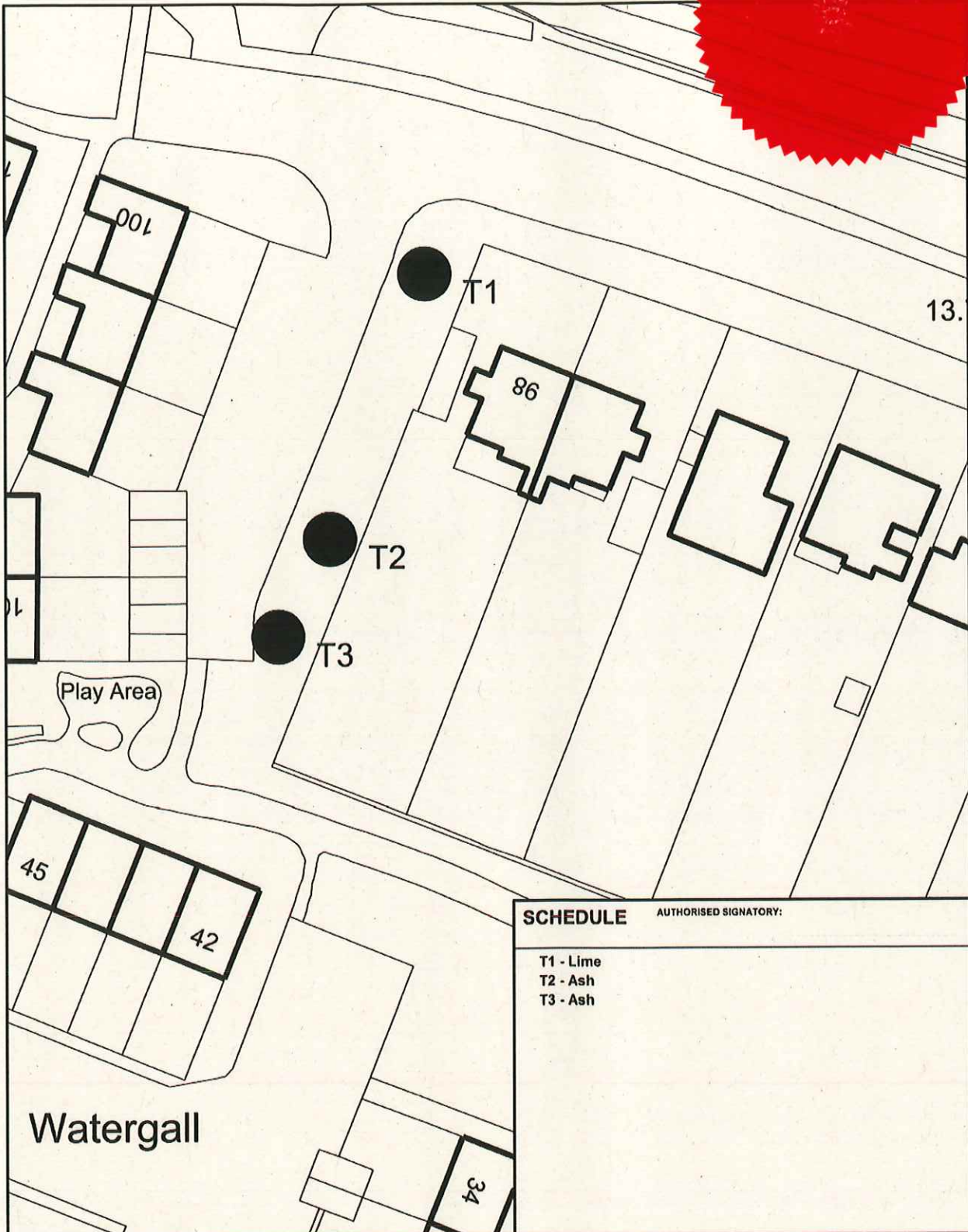

SCHEDULE

AUTHORISED SIGNATORY:

- T1 - Lime
- T2 - Ash
- T3 - Ash

TREE PRESERVATION ORDER 14/00005/TPO
Land at 98 Linkside Bretton

Scale 1:500 Date 3/7/2014 Department Serco GIS Support Name DB PCC GIS

© Crown copyright and database right 2012. Ordnance Survey. 100024236.



PETERBOROUGH
CITY COUNCIL

**PETERBOROUGH CITY COUNCIL
TOWN AND COUNTRY PLANNING ACT 1990
TOWN AND COUNTRY PLANNING
(Tree Preservations)(England) Regulations 2012**

Tree Preservation Order No.: 14/00005/TPO
relating to Land adjacent to 98 Linkside, Bretton
dated: 27 August 2014

This order was confirmed by The Council of the City of Peterborough.

on 5 December 2014

Signed on behalf of The Council of The City of Peterborough

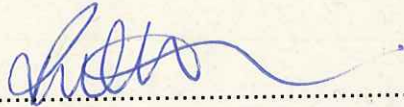

.....
Authorised by the Council to sign in that behalf

